

GENERAL

- Red Line Boundary
- Proposed Levels
- Proposed Contour Adjustments
- Proposed Mounding
- Permanent Water Body

HARDWORKS

- Path Type 1
- LEAP Play Area
- Timber Steps Type 1 & 2

SOFTWORKS

- Existing Hedge
- Existing Hedge Removed
- Existing Trees Retained
- Grass Paths
- Species Rich Short Grassland
- Naturalistic Grassland
- Naturalistic Wildflower Meadow
- Detention Basin Planting Mix
- Edible/ Wild Edge Planting
- Mixed Bulb Planting

FURNITURE

- Seat
- Bench
- Picnic Bench
- Litter Bin
- Dog Bin
- Timber Bollards
- Cycle Stands
- Master Mile Markers
- F1 Main Park Signage

BOUNDARY FEATURES

- Timber Knee Rail
- Traditional Estate Railing
- F3 Feature Gateway Marker
- Feature Tree Guards

PLAY FEATURES

- Informal Boulders
- Feature Tree Play
- Informal Play Feature

ECOLOGICAL FEATURES

- Ecological Stack
- Bat Box
- Bat Box
- Bat Box
- Bird Box
- Bird Box

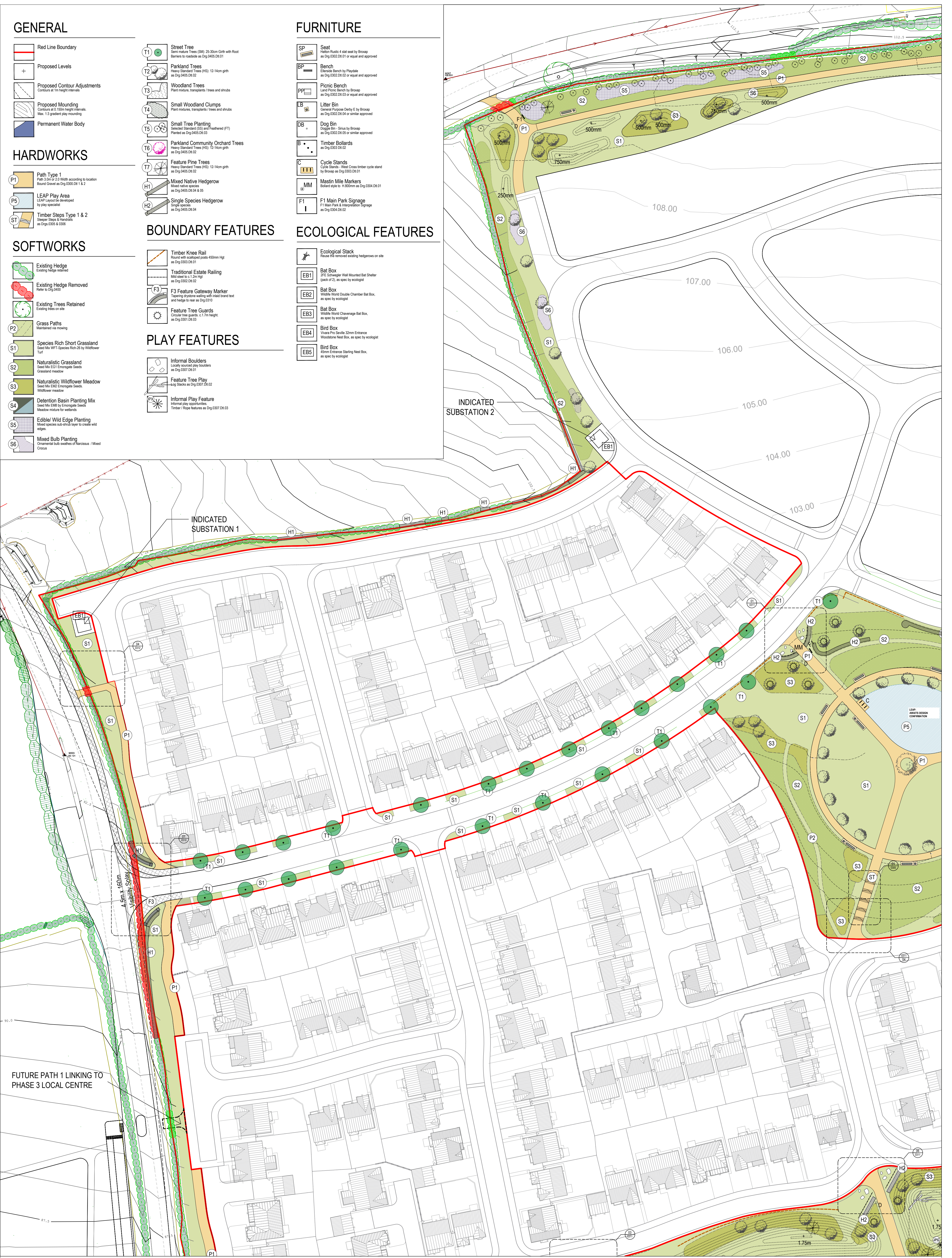

rev	details	by	date
00	DRAFT ISSUE FOR COMMENTS	LY	28.09.2022
01	REVISED AGAINST LA COST PLAN & SITE ACCESS CLEARANCE	LY	28.10.2022
02	TENDER PACK DRAFT ISSUE	LY	09.12.2022
03	ISSUE FOR REVISED TENDER PACK	LY	23.12.2022

Notes

- 1.0 Do not scale from drawing, use figured dimensions only
- 1.1 All dimensions to be checked onsite
- 1.2 This drawing to be read in conjunction with all other Gillespies drawings and specifications

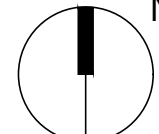

DRAFT

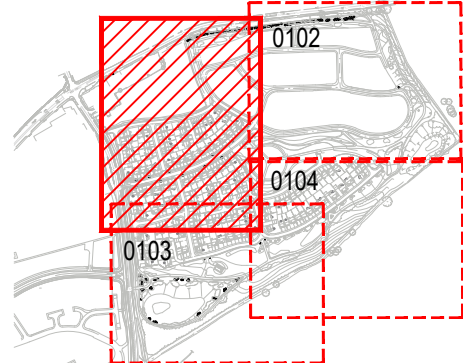

Project title
MASTIN MOOR
PHASE 1 & 2

Drawing title
LANDSCAPE GA PLAN
SHEET 1 OF 4

© copyright GILLESPIES LLP, all rights reserved

Drawing number
P21055-00-001-GIL-0101

Drawing Status
TENDER

Date
22.09.2022

Scale
1:500 @ A1

Drawn
RB

Checked
TW

The Devonshire Property
(MM) Limited

GILLESPIES

19th Floor, Phoenix House, 3 South Parade, Leeds, LS1 5DN
P: 0113 247 0550 F: 0113 247 0660 E: design.leeds@gillespies.co.uk